

# NARSF104

3PC内螺纹球阀M3  
3PC Ball Valve M3 Type 1000WOG

Threaded Ball Valves

## 产品特点 / FEATURES:

阀杆带有防脱出装置设计 Blow-out Proof Stem  
钢球球槽上有泄压孔设计 Pressure Balance Hole In Ball Slot  
可选择挂锁装置 Lock Device  
采用脱蜡精密铸造  
Using Dewaxing Precision Casting

## 标准 / STANDARDS:

设计标准 / Design: ASME B16.34  
壁厚标准 / Wall Thickness: ASME B16.34  
结构长度 / Face to Face: DIN 3202-M3  
螺纹标准 / Pipe Thread: ASME B1.20.1, BS21  
DIN 2999/259, ISO 228/1 JIS B 0203, ISO 7/1  
对焊标准 / Butt Weld: ASME B16.25  
承插焊标准 / Socket Weld: ASME B16.11  
检测标准 / Inspection & Testing: MSS SP-110, EN 12266

No.	PARTS NAME	MATERIAL		
1	阀体/Body	CF8M	CF8	WCB
2	螺母/Nut	SUS304		
3	阀盖/Cap	CF8M	CF8	WCB
4	球体/Ball	CF8M	CF8	
5	阀座/Seat	PTFE	RPTFE	
6	止推垫片/Thrust Washer	PTFE		
7	密封圈/Cap Gasket	PTFE		
8	弹簧垫圈/Spring Washer	SUS304		
9	填料/Stem Packing	PTFE		
10	填料压盖/Nut Gland	SUS304		
11	弹簧垫圈/Spring Washer	SUS304		
12	螺母/Nut	SUS304		
13	阀杆/Stem	SS316	SUS304	
14	锁片/Locking Device	SUS301		
15	手柄/Handle	SUS304		
16	手柄套/Handle Cover	Plastic		
17	双头螺栓/Bolt	SUS304		

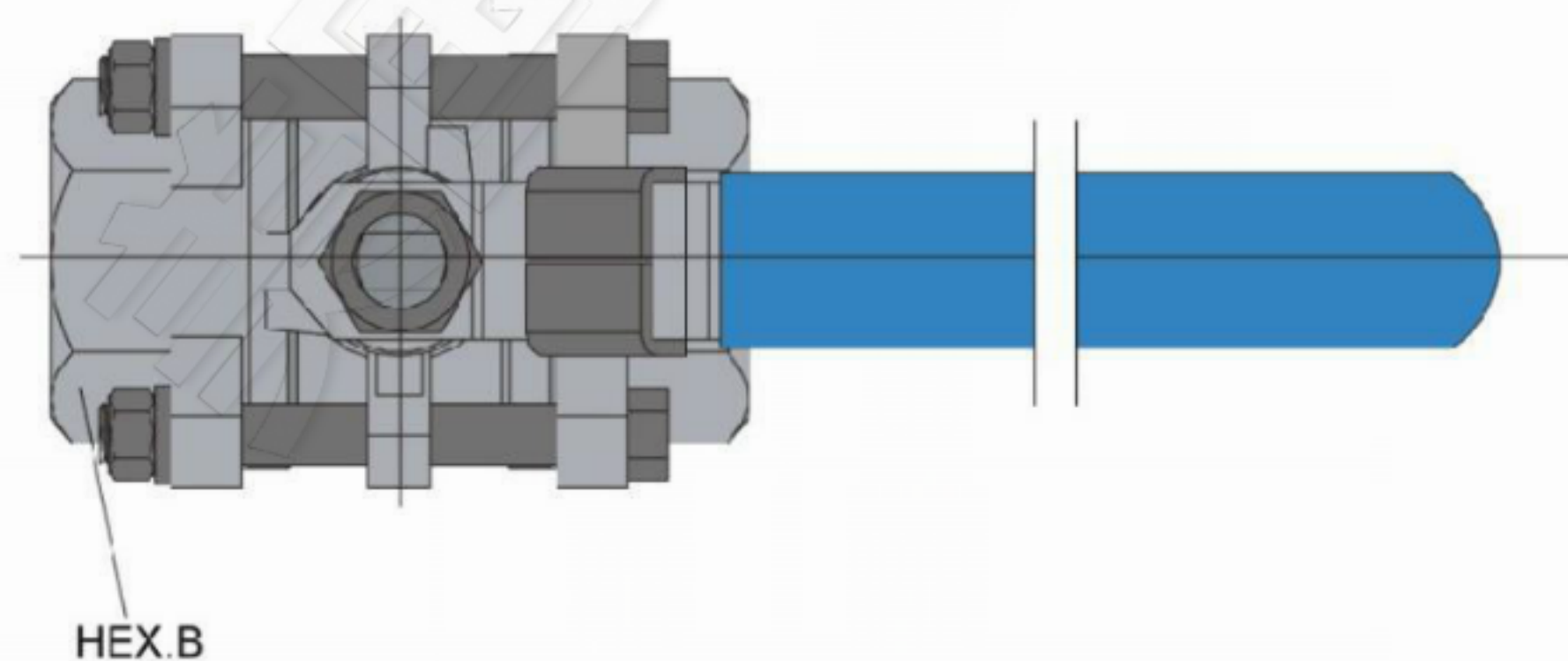
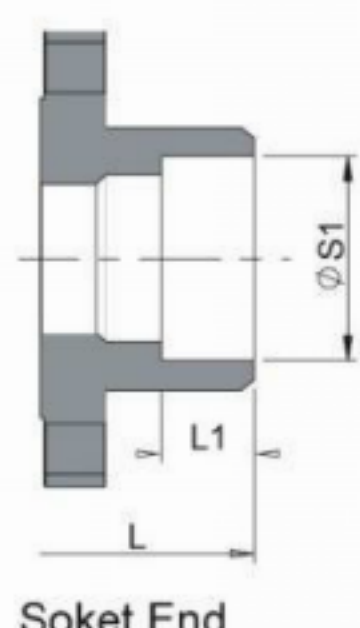
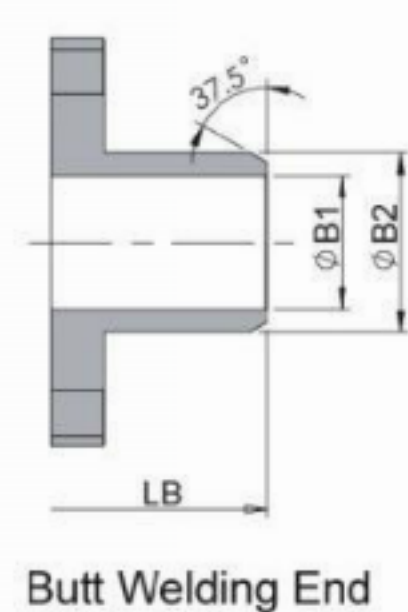
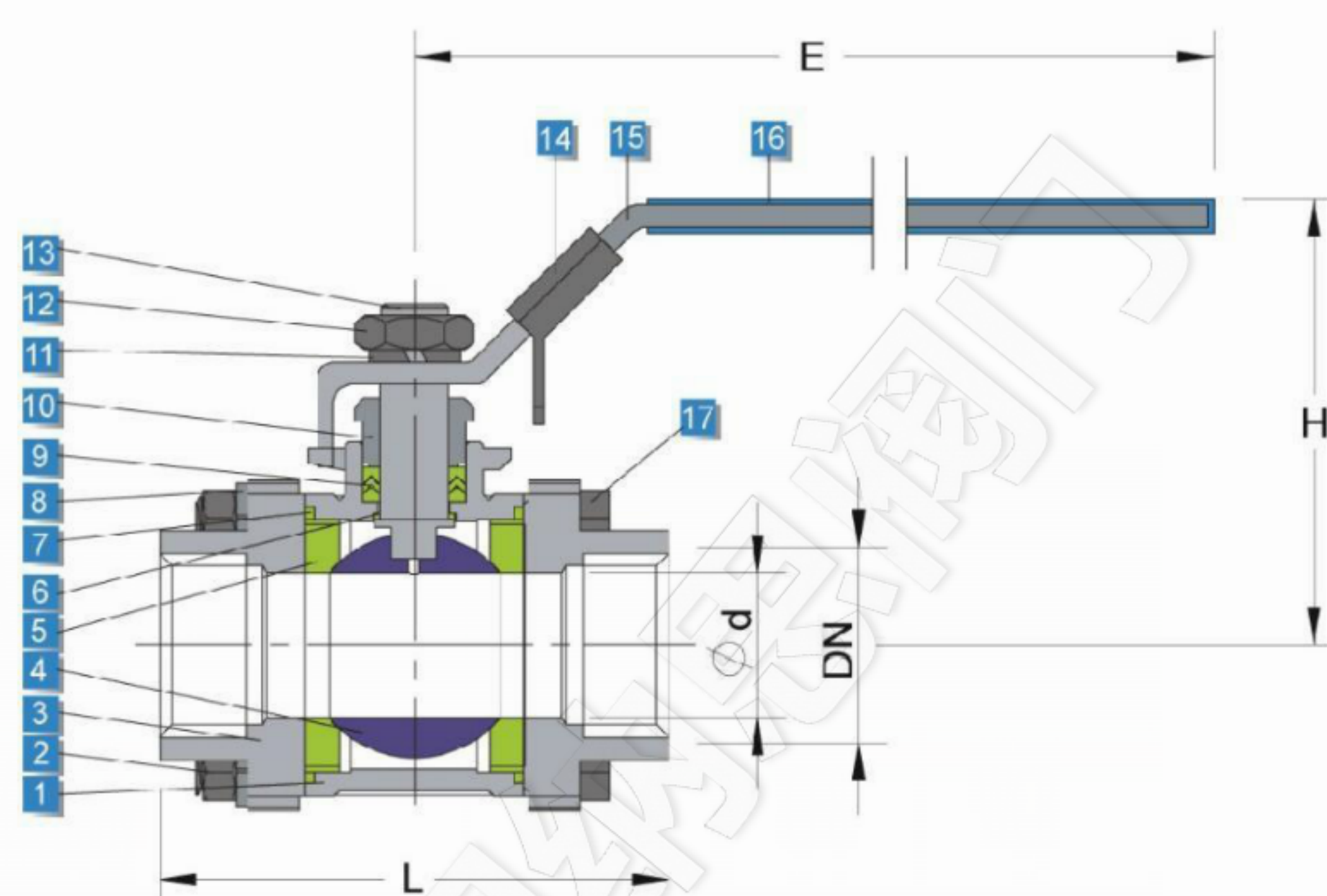

Unit:mm

DN	L	Ød	H	E	L1	ØS1	LB	ØB1	ØB2	HEX.B	THREAD
1/4"	50	10.5	51.5	98	10	14.2	70	12.5	18	19	NPT BSP PT DIN BSPT etc.
3/8"	60	12	58	98	10	17.8	70	12.5	18	22	
1/2"	75	15	64.5	120	10	21.8	75	16	22.5	27	
3/4"	80	20	67	120	13	27.3	90	21	27	32	
1"	90	25	78.5	150	13	34	100	26	34.5	40	
1-1/4"	110	32	83.5	150	16	42.8	110	32	43	50	
1-1/2"	120	38	98	170	16	48.9	125	40	49	55	
2"	140	48	107	170	17	61.4	150	51	62	68.5	
2-1/2"	185	65	133	250	17	74	190	65	76.5	85	
3"	205	78	143.5	250	17	90	220	80	92	100	
4"	240	100	168	305	20	115.4	270	100	115.5	126	